

Access Statement – Sound of the Sea – Self Catering



Sound of the Sea is a 2nd floor seafront apartment with stunning views across Port Erin Bay, from Bradda all the way across to the Calf of Man. The majestic sight of the sun setting over Bradda Head will be unforgettable.

The apartment is located in Spaldrick, which is reached approximately 1/2 Km up the hill towards Bradda from Port Erin Promenade. It is located in a Georgian town house that has been converted into 3 apartments, **Sound of the Sea** is on the 2nd (top) floor and is split over 2 levels. It sleeps 5 adults, with one twin and one single bedroom (and main bathroom) on the lower level and upstairs in the converted attic is a further master double bedroom with en suite shower room and views over the bay. On the lower level, there is a lounge and dining room that also both overlook the bay with stunning views, as well as a modern kitchen and newly-fitted bathroom.

Well-behaved dogs are welcome.

Contact information:

The Apartment is managed by local Isle of Man holiday cottage company Island Escapes. You can find further details on their website www.islandescapes.im.

Contact details are:

Phone - 01624 830200

Email - visit@islandescapes.im

Where we are

Port Erin is on the southwest tip of the Isle of Man, with Spaldrick being approximately halfway between Port Erin and Bradda. The main beach at Port Erin is a 10 minute walk from the apartment and is a large family-friendly, sandy beach that offers a variety of amenities and water sports. There are also a number of small rustic pebble beaches, including Spaldrick beach, which can be reached down the steps directly opposite the apartment. The property sits on the Manx coastal footpath, which can be accessed via an archway also directly opposite the apartment. This footpath heads through the beautiful Bradda Glen before taking you along the cliffs and up to the Bradda headland where the views extend across to the Calf of Man and Ireland.

Directions from Port Erin

The apartment can be found at the foot of Bradda Hill driving up from Port Erin Promenade or town centre, towards the village of Bradda.

Spaldrick is formed by a small group of properties that are located just past the Rowany golf course. Once past the golf course, there are a row of town houses on the right hand side of the road. **Sound of the Sea** is located on the top floor of the second property (painted yellow), next door to The Waverly.

Google maps link -

<https://goo.gl/maps/h5zUphbRgvaHFL5e9>

Public Transport Routes

Information on bus and train services can be found on www.iombusandrail.im/

You can search all routes at www.traveline.info

Frequent buses run from Douglas and the airport to Port Erin and the nearest bus stop to the apartment is approximately a 10 minute walk in Port Erin town centre. You can also travel to and from Port Erin on the unique and well maintained steam train line that runs to Douglas and other locations in the south of the Island (generally operating from March to October). Port Erin is the final stop on the line.

Transport

Bus

Douglas to Port Erin, via airport and Castletown – 1,2,11,12, N1

Taxis

available from outside the ferry terminal and airport

Port Erin Taxis -

A.A.Airport - 07624 406802

Ayres Taxis - 01624 818118

Lezayre Cabs Taxi Service - 07624 429111

Manx Taxis - 01624 817788

Connect Villages door to door bus service

www.iombusandrail.im/minibuses/connectvillages/

ConnectVILLAGES is an on-demand bus service with no fixed timetable. It responds to requests and collects multiple passengers all heading in the same direction.

Booking can be made using the MANNgo app or by calling 697440 between 8.30am and 4.30pm Monday to Friday.

Train stations – Manx steam railway runs between Douglas and Port Erin from March to October. Port Erin train station is located in the centre of Port Erin in close proximity to the beach, shops, cafes and restaurants; and is approximately a 15 minute walk from the apartment – you can find more information and other railways services on the island at - www.iombusandrail.im/heritage/our-railways/manx-electric-railway/

Parking and outside the property

There is a car park at the rear of the property with a dedicated parking space for the apartment, there is also ample free street parking for multiple cars at the front of the property.



The property is accessed by steps and staircase and hence is not wheelchair accessible.

Facing the property across the road is the entrance to Bradda Glen, a sloped path that goes down through the glen to Bradda Glen café before climbing along the cliffs and up to Bradda Head. There is also a stepped path down to Spaldrick beach and the coastal footpath down to Port Erin.

Entering the property

Access to the main front entrance of the property that contains 3 apartments is up a set of 11 steps that leads into a communal porch and hallway. Sound of the Sea is then reached up two flights of stairs (34 steps) and is located at the top of the townhouse. The apartment has its own lockable front and back door. The back door leads directly down to the car park at the rear of the property via an external metal fire escape staircase.

On entering the front porchway through an unlocked porch door, there is a locked communal access front door with a push handle. The hallway and staircase contain safety lighting and additional push button lighting that is on a timer. Once at the top of the staircase, access to the apartment is through a Yale-locked front door.

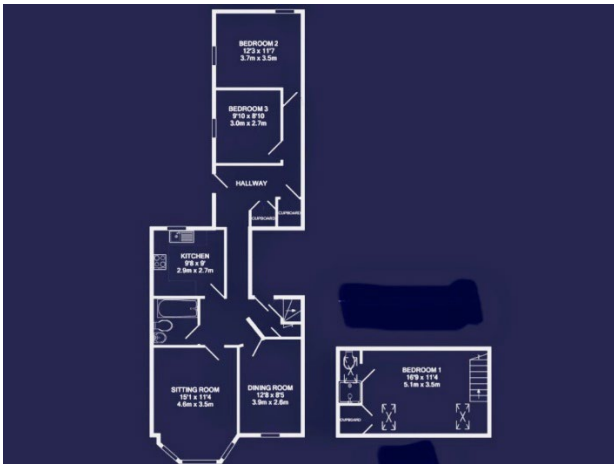

There are two bedrooms on the lower level and the main bathroom, that consists of a toilet, sink and bath/shower. The upper level consists of master bedroom and en suite is accessed via a steep staircase with 13 steps, sidewalls and handrail. The en suite contains a toilet, sink and shower.

Table and chairs are provided in the dining room and all furniture can be moved if required.

Shopping

There are 2 supermarkets in Port Erin (5 min drive), a large Shroprite and smaller Co-Op. Tesco (Douglas) and Co-op both offer online delivery should you wish to organise in advance. Port Erin town centre also has a number of smaller shops including a newsagents, post office, chemist, pet shop and a variety of gift shops.

Restaurants/Cafes

Port Erin has a good selection of places to eat in and takeaway including fish and chips, Chinese, Indian, pizza, pubs, local cafes/restaurants.

Bars/Pubs

There are a number of places to socialise including Foraging Vintners, The Station, The Bay and Falcons Nest.

Please contact Island Escapes to discuss any requests or requirements that they may be able to assist with and they will endeavour to accommodate.